

THE UNITED STATES LINER "AMERICA"

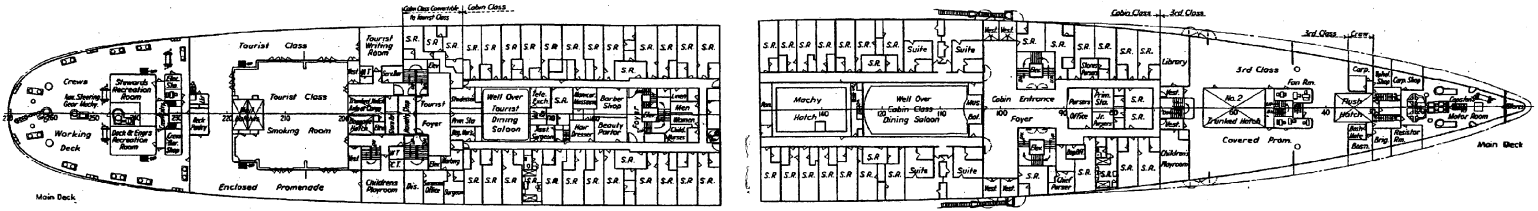

S.S. "AUSTRALIS"

MAIN DECK

CABINS 1-5 BEATHS 441

MAIN DECK

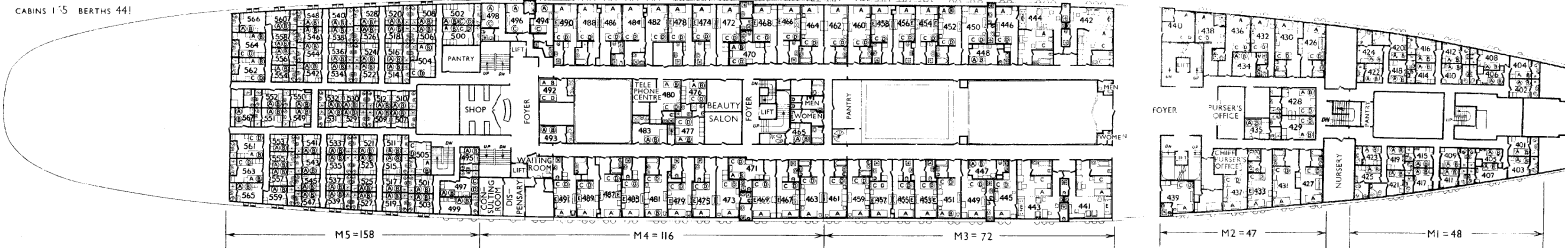

THE UNITED STATES LINER "AMERICA"

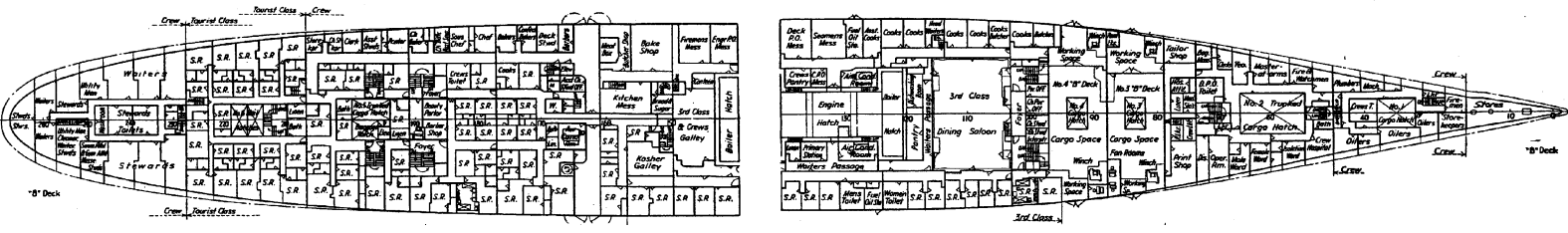

S.S. "AUSTRALIS"

"B" DECK

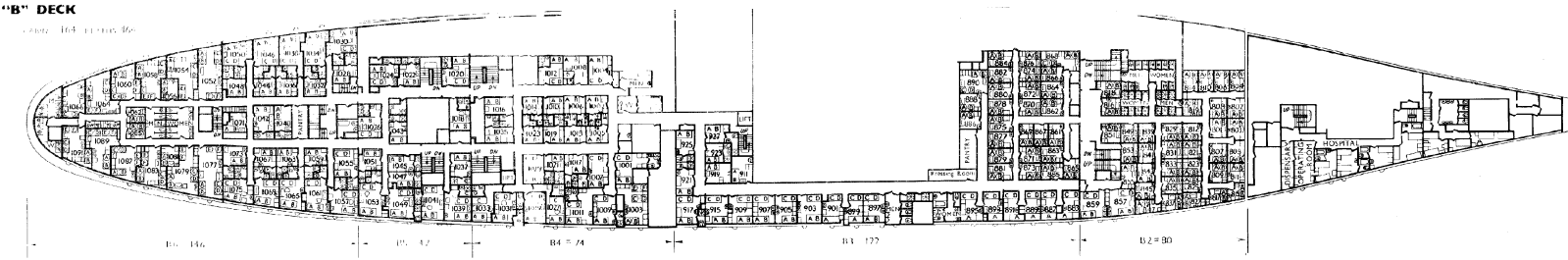

THE UNITED STATES LINER "AMERICA"

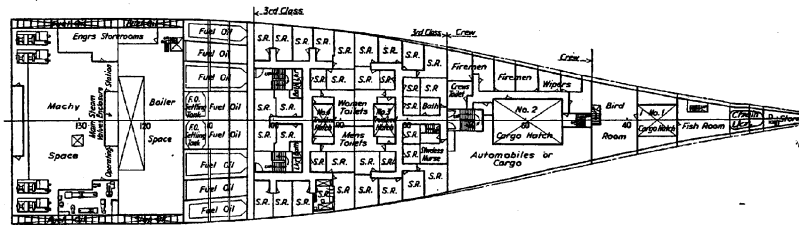
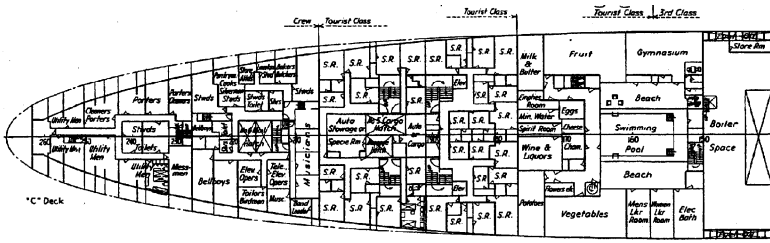

S.S. "AUSTRALIS"

"C" DECK

CABINS 85 BERTHS 368

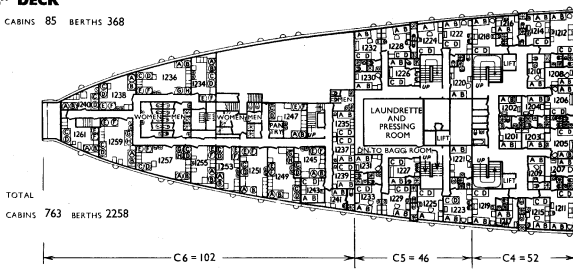

TOTAL
CABINS 763 BERTHS 2258

C6 = 102

C5 = 46

C4 = 52

"C" DECK

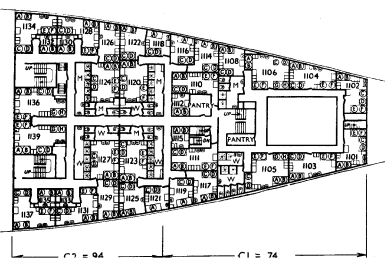

C3 = 94

C1 = 74

THE UNITED STATES LINER "AMERICA"

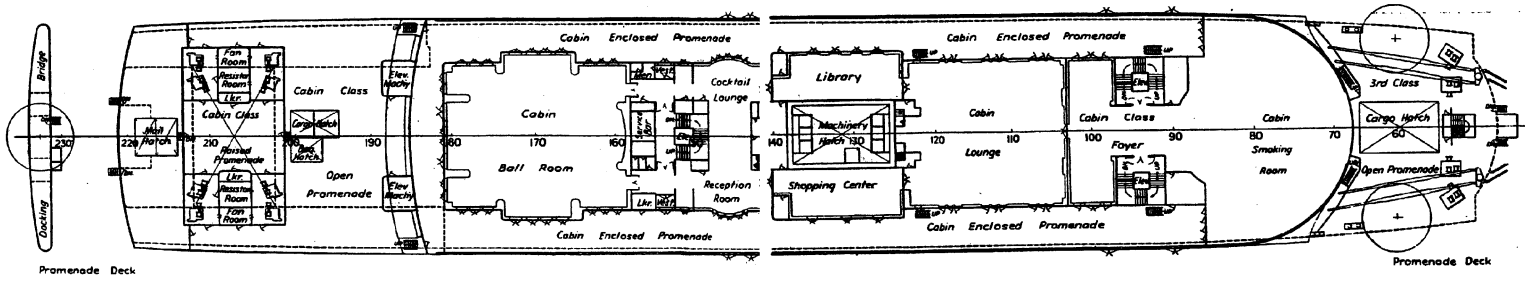

S.S. "AUSTRALIS"

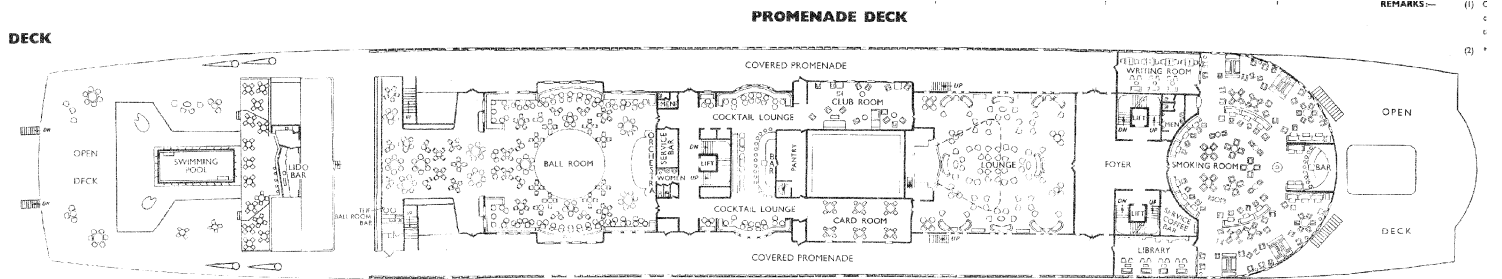

THE UNITED STATES LINER "AMERICA"

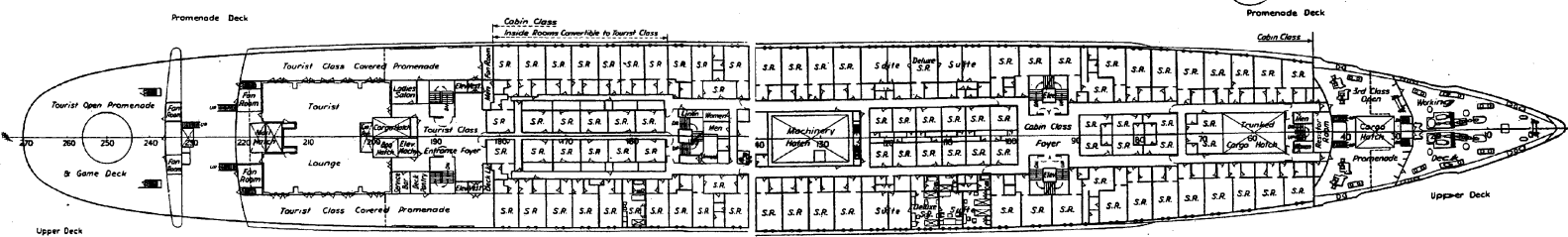
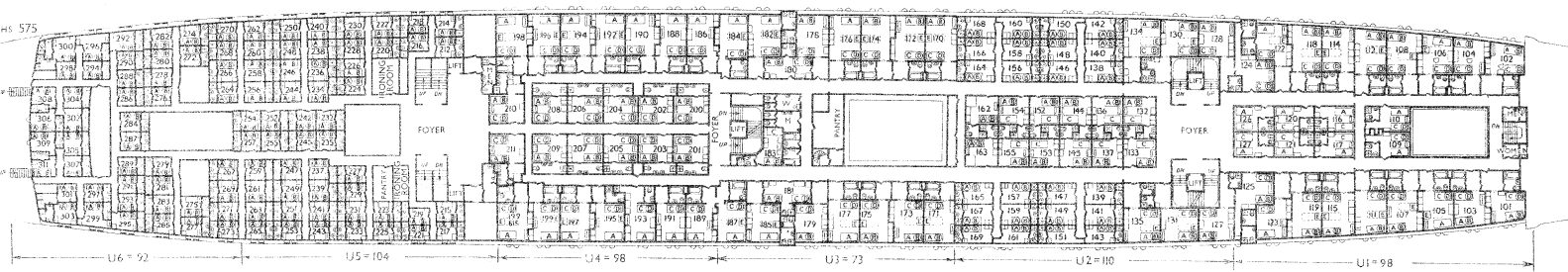

FIG. 7.—UPPER, PROMENADE, SUN AND SPORTS DECKS AND TOPS OF HOUSES

S.S. "AUSTRALIS"

UPPER DECK



THE UNITED STATES LINER "AMERICA"

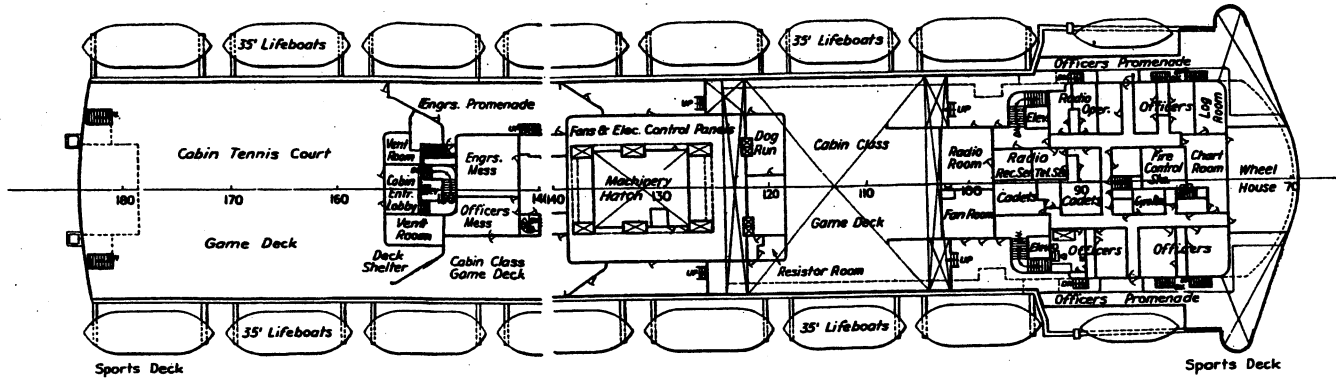

S.S. "AUSTRALIS"

SPORTS DECK

